

VERTICAL EXPANSION JOINT AT DISSIMILAR CLADDING

- ① Backer Rod at expansion joint
- ② Transition material
- ③ Substrate
- ④ Water Resistant Barrier
- ⑤ Vertically Notched Adhesive or grooved insulation for drainage
- ⑥ Backer Rod and Sealant, Sealant applied to base coat as per sealant manufacturer instructions
- ⑦ Back-wrapped insulation board (Pre-wrapped preferred)
- ⑧ Insulation Board
- ⑨ Reinforcing mesh embedded in Base Coat
- ⑩ Finish Coat (over finish coat primer if specified)
- ⑪ Dissimilar Cladding

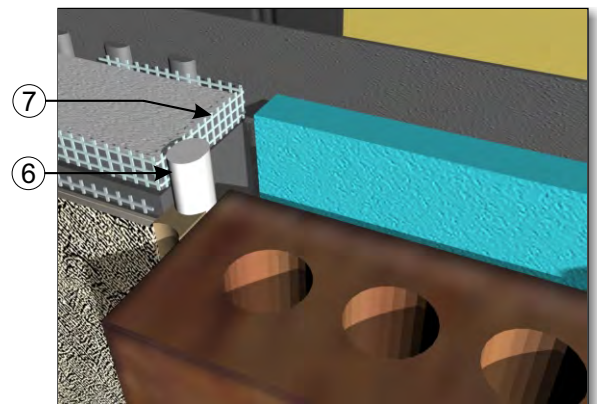

DISCLAIMER:

Any user of this EIFS Practice Manual is expressly bound by the Waiver and Disclaimer set out within this Manual. This illustration is a proprietary component of the EIFS Practice Manual and is subject to full copyright protection."